

## R151T60B

printed on: 24-04-2025



### TECHNICAL INFO

|                     |              |
|---------------------|--------------|
| Media type          | WIRE MESH    |
| Efficiency          | 60 µm        |
| Flow direction      | OUT-IN       |
| Collapse $\Delta p$ | 10 bar       |
| Bypass setting      | 1.7 bar      |
| Seals               | NBR          |
| Temperature range   | -30°C +100°C |

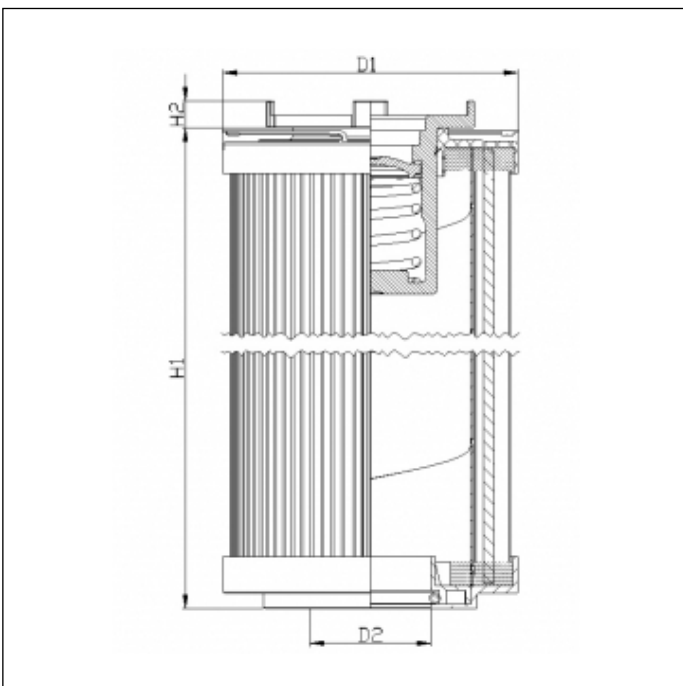

### OVERALL DIMENSIONS

|    |          |
|----|----------|
| D1 | 130,0 mm |
| D2 | 51,5 mm  |
| H1 | 200,0 mm |
| H2 | 9,0 mm   |

Technical information may change without notice. Image and drawing are representative only