

TECHNICAL INFO

Media type	WIRE MESH
Efficiency	25 µm
Flow direction	OUT-IN
Collapse Δp	bar
Seals	NBR
Temperature range	-30°C +100°C

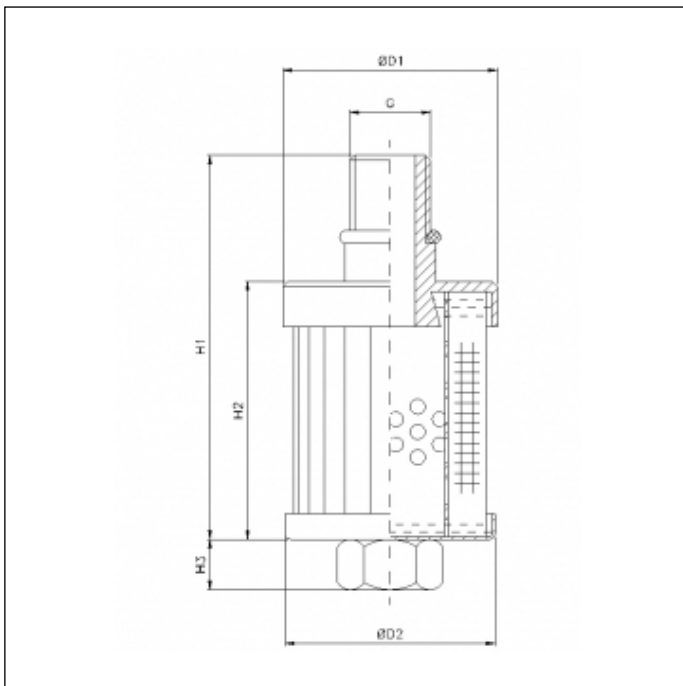

OVERALL DIMENSIONS

D1	42,5 mm
D2	41,5 mm
H1	96,0 mm
H2	71,0 mm
H3	10,0 mm
G	M 16x1,5